

**TECHNICAL INFORMATION**

SPECIFICATIONS	METRICS	IMPERIAL
Drive Train	2 x 1kW motors	11.2bbs
Weight (excl Battery)	58.7kg	48.4in
Height	1,825mm	32in
Seat Height	815mm	33in
Width (Handlebars)	840mm	72in
Length	1,820mm	47.8in
Wheelbase	1215mm	330lbs
Payload (incl rider)	150kg	5.12in
Suspension - Front	130mm adjustable	4.72in
Suspension - Rear	120mm adjustable	75mi
Range (Max Tested)	120km	30mph
Max Speed	50km/h	(EU 45km/h limited)

**VEHICLE CLASS**  
 WMC PIN coded off road vehicle. **NOT** road registrable.  
 • CE Compliant for off-road use in Europe. Can be registered as a farm/work vehicle in some European jurisdictions.  
 • RVCs approved for off-road use in Australia. Can be approved for a conditional registration for farm use.  
 • Compliant for off-road use in NZ.

**Note:** Check your local licensing laws to determine license requirements. All information in this publication is based on the latest production information available at the time of approval for printing. UBCO Ltd reserves the right to make changes at any time without notice.

**ACCESSORY LUGS**

The 2x2 features 19 individual accessory lugs that are strategically placed across the frame to provide flexibility and adaptability. The lugs use standard M8 nuts and bolts for attaching tie downs, mounts, and accessories. Inside each lug is a cavity to hold an M8 nut in place, preventing it from spinning as the bolt is tightened or loosened.

The front rack is attached via two lugs at the front of the main frame. These lugs can be utilized for other attachments when the front rack is removed.

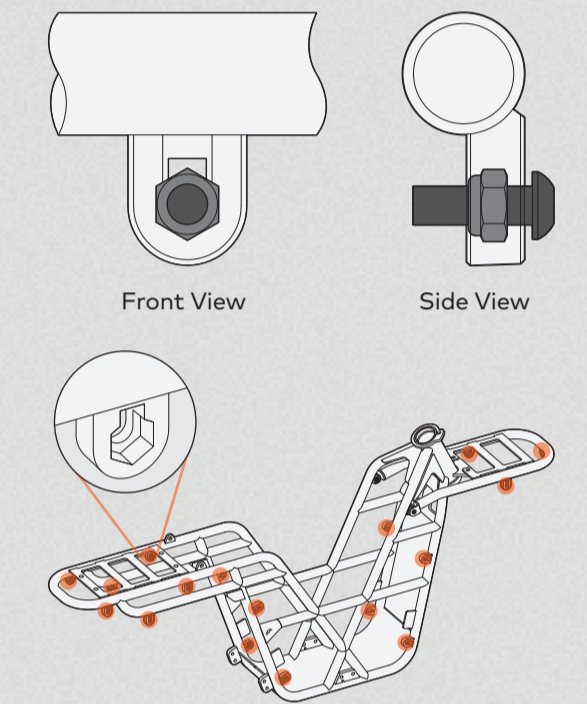

**SUSPENSION RECOMMENDATIONS**

	FRONT REBOUND	FRONT SPRING	REAR REBOUND	REAR SPRING
Hard Ground Rider Only (90kg)	Max fast	Full soft	Max fast	28mm thread exposed
Hard Ground + Load (125kg)	Max fast	1 full turn to hard	4 clicks towards slow	28mm thread exposed
Soft Ground Rider Only (90 kg)	Max fast	Full soft	2 clicks towards slow	38mm thread exposed
Soft Ground + Load (125kg)	Max fast	1 full turn to hard	6 clicks towards slow	38mm thread exposed

**Note:** Hard Ground refers to dry tracks; soft ground might be tall grass, mud, or sand.

**WHEELS**

Each tire on your 2x2 uses a standard, car style valve for inflation and deflation.  
 The 9-gauge stainless steel spokes in a tangential double-crossed pattern provide extra wheel strength on DOT compliant aluminum rims.  
**Tires:** Supplied with 17x2.75" off-road knobby tires. Only use tires with a minimum load capacity of 37 and minimum speed category of B.  
**Recommended Tire Pressure:** 287 kpa | 25 psi or as specified on the tire.

**MEASUREMENTS**

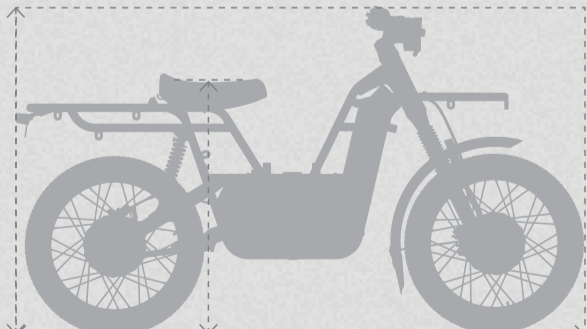

**LENGTH:** 1.8m | 6ft  
**WIDTH:** 0.84m | 33in  
**WHEELBASE:** 1.2m | 4ft  
**HEIGHT:** 1.82m | 3.37ft  
**SEAT HEIGHT:** 0.8m | 32in

# Key Features of Your 2x2 Electric Motorbike

## 2023 WORK MODEL

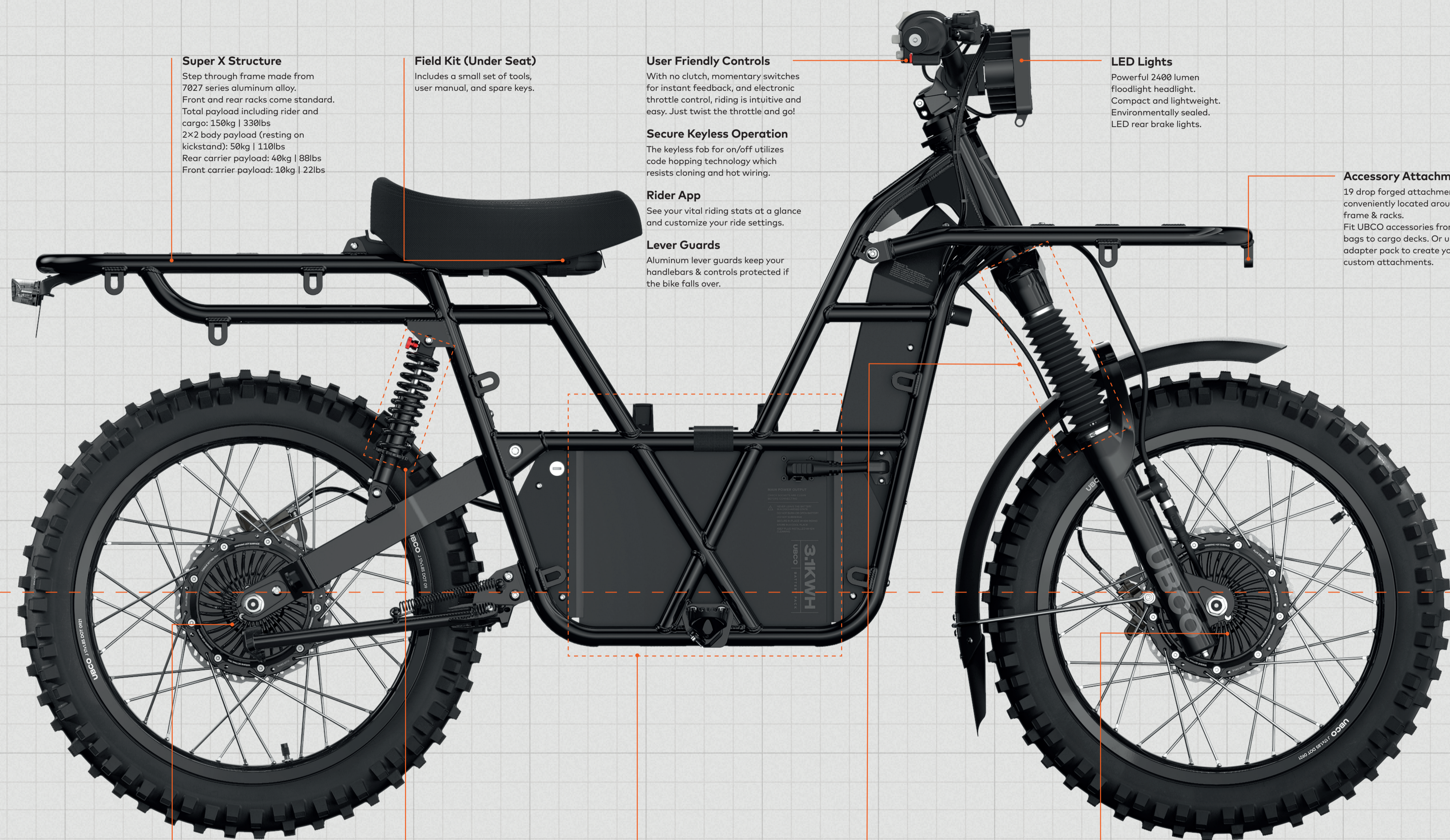

**Super X Structure**  
 Step through frame made from 7027 series aluminum alloy. Front and rear racks come standard. Total payload including rider and cargo: 150kg | 330lbs  
 2x2 body payload (resting on kickstand): 50kg | 110lbs  
 Rear carrier payload: 40kg | 88lbs  
 Front carrier payload: 10kg | 22lbs

**Field Kit (Under Seat)**  
 Includes a small set of tools, user manual, and spare keys.

**User Friendly Controls**  
 With no clutch, momentary switches for instant feedback, and electronic throttle control, riding is intuitive and easy. Just twist the throttle and go!

**Secure Keyless Operation**  
 The keyless fob for on/off utilizes code hopping technology which resists cloning and hot wiring.

**Rider App**  
 See your vital riding stats at a glance and customize your ride settings.

**Lever Guards**  
 Aluminum lever guards keep your handlebars & controls protected if the bike falls over.

**LED Lights**  
 Powerful 2400 lumen floodlight headlight. Compact and lightweight. Environmentally sealed. LED rear brake lights.

**Accessory Attachment Lugs**  
 19 drop forged attachment lugs conveniently located around the bike frame & racks. Fit UBCO accessories from pannier bags to cargo decks. Or use the adapter pack to create your own custom attachments.

**High Torque Geared Drivetrain**  
 All-wheel drive via 2 x 1kW hub motors. Designed for on-road and off-road conditions. Sealed bearings, fully splined gear interfaces. Max speed: 50kph | 30mph

**Rear Suspension**  
 120mm Adjustable Rebound Controls. Spring preload adjustment.

**High Capacity Lithium Ion Battery**  
 Sturdy alloy case, weatherproof to withstand rain and washing. Intelligent battery management system (BMS) keeps your battery in good health. Multiple safety mechanisms designed in. Charge time: 4-6hr (Includes Fast Charger)  
 Max Range: 120km | 75mi (noting that real-life variables such as speed, weight, and terrain will impact range).

**Front Suspension**  
 130mm Adjustable Rebound Controls. Spring preload adjustment.

**Silent Motors**  
 2x 1kW Hub Motors  
 Max speed: 30mph | 50kph  
 Near silent motors let you enjoy the sounds around you without adding any noise pollution of your own.

**Regenerative Braking**  
 UBCO regen braking system enables the motors to do some of the braking work, saving brake pad wear, and helping recharge the battery at the same time.

**Max Submersion Depth**  
 Do not submerge the 2x2 above the axles. This could damage the bike and void the warranty.



**DESIGNED IN NEW ZEALAND. BUILT FOR ADVENTURE.**

**DESIGNED FOR DISASSEMBLY. BUILT FOR THE PLANET.**

**DESIGNED FOR FUN. BUILT TO LAST.**

